

# NEWSLETTER

FEATURED: RESIDENTIALS | COMMERCIALS | GODOWNS | PLOTS

## Dunhill's Diwali Dhamaka



### EMPIRE BUSINESS PARK

*"The best warehousing complex in Ruaraka"*

**Sale Price: Ksh. 5,150 psf**

Completion: December 2023 | 40M Road | Type A: 7,530 sq.ft  
Type B: 11,696 sq.ft

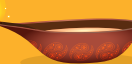
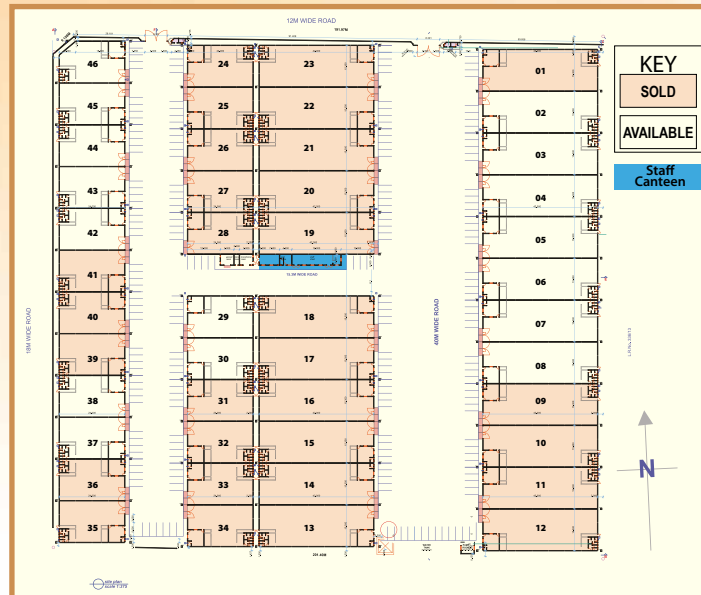



**4 Bed House**

## Birchwood Villas

### Shanzu Rd, Spring Valley

Located in an exclusive neighborhood in one of the most prolific suburbs of Nairobi, Birchwood Villas is a unique development of 4 bedroom townhouses on Shanzu road, Spring Valley. These houses are designed to meet the specifications of the discerning home buyer looking for a tranquil living environment in a very secure location coupled with the convenience of urban living.

#### Features:

- Spacious Living Room & Separate Dining Room
- TV Room on the ground floor
- Large Kitchen with Pantry
- Large Underground Water Tank
- 24 hours Security
- Visitors Parking Space
- Boundary Wall with Electric & Razor Fence



**4 Bed House**

## Elite Gardens

### Grevillea Grove, Brookside

This stunning and secure 4-bedroom house is situated in the serene and quiet environs on Grevillea Grove, Brookside.

The lower level features a beautifully designed open plan dining room and sunken lounge which opens up to a sizeable patio and well-manicured garden. There is one en-suite bedroom which can be used as a guest room. The upper level features 3 en-suite bedrooms and a spacious family entertainment area.

#### Features:

- Borehole
- DSQ
- Geyser Water Heating
- Guarded Security
- Parking
- Underground Water Tanks
- Well-Manicured Small Garden



**4 Bed House**

## 23 Bendera Heaven

### Bendera Lane, Spring Valley

This stunning 4-bedroom house is located on Bendera Lane, Spring Valley Estate, nestled in a serene gated compound, surrounded by lush greenery. The house sits on 0.5 acres, and has a lovely mature garden. Offering a truly tranquil oasis in the heart of the city, where you can escape the hustle and bustle and experience the ultimate in contemporary living, with sleek, modern finishes.

#### Features:

- Backup Generator
- Cinema Room
- DSQ
- Garden
- Parking
- Patio
- Terrace



**5&6 Bed House**

## The Cycads

### Mimosa Gardens, Runda

These exclusive and luxurious homes in the prestigious area of Runda are strategically designed to create an exceptional living environment combining luxury, practicality and privacy.

The design offers the best of cozy living yet offering lavish luxury space.

#### Features:

- All bedrooms en-suite
- Guest bedroom/study on ground floor
- Master bedroom with additional dressing room and his and hers bathroom.
- Large family kitchen with breakfast area
- External kitchen/dhobi area
- Two store rooms
- Staff quarters
- Long external covered terrace complete with barbeque area fronting private garden



**1 Bed House**

## Gigiri House

Lobelia Drive, Gigiri

**Fully Furnished**

This cozy 1-bedroom fully furnished guest house, is located in the secure and serene environs of Gigiri, within a gated compound.

The house features a charming living room with a well equipped kitchen. The compound has ample parking and good security. The rent includes all the utilities.

**Features:**

- 1 Bedroom
- 1 Bathroom
- Gated Compound
- Parking
- All Bills included in the rent
- 24/7 hour security
- Borehole water is available



**6 Bed House**

## Gem Lane

Gem Lane, Kileleshwa

Strategically located on Gem lane in the popular area of Kileleshwa, is this prime residential property that sits on approximately 0.5 acres. This secure house features 6 spacious bedrooms and a guest house, with a large well-manicured garden.

**Features:**

- 6 Bedrooms
- Guest House – 2 Bedroom
- Sufficient parking for Eight or more cars
- Spacious Garden
- Wooden Flooring
- Gated Compound



**2 Bed House**

## Juu House

Mutundu Road, Old Muthaiga

**Fully Furnished & Serviced**

Indulge in the allure of this gorgeous 2-bedroom house. Located on Mutundu Road, Old Muthaiga, this property is situated within close proximity to malls, schools, hospitals, restaurants and other social amenities.

**Features:**

- 2 Bathrooms
- Daily Cleaning Service
- Laundry Service
- Security
- Internet
- Water



**8 Bed House**

## Pinewood Grove

General Mathenge, Westlands

This stunning property offers an exceptional living experience in the heart of General Mathenge. Situated in a highly sought-after gated community, this gorgeous double storey home combines comfort, convenience and security.

**Features:**

- Property sits on 0.5 Acres
- 8 Bedrooms
- 6 en-suite
- Garden
- Ample Parking
- DSQ
- Gated estate



**4 Bed  
Apartment**

## 33 Wind Chimes General Mathenge, Nairobi

This development is an exquisite and rare collection of coveted real estate development at the most sought-after location General Mathenge Drive, Westlands.

### Features:

- 3 towers of 11 storeys each on 1 acre
- 1 apartment on each floor
- 2 lifts per tower: 1 service + 1 standard lift
- 4 dedicated parking slots per apartment
- DSQ with separate entrance/exit
- 3,600 sqft clubhouse with 12.5m heated pool, massage room, dedicated gym, table tennis & darts, members lounge, pool room, separate steam & sauna for ladies & gents
- Borehole & underground & rooftop water storage
- Full back-up generator
- Intercom system
- 24hr security & CCTV
- Children's play area



**4 Bed  
Apartment**

## Eastfield General Mathenge, Nairobi

This apartment has been carefully designed to maximize space and natural light, as well as creating a relaxing environment for you to create your perfect home.

### Features:

- Four bedroom all en-suite apartment with DSQ cloakroom and prayer room
- 2 no. Lift in the middle of the block
- Borehole water supply / R.C.C underground water tank
- Full Backup Generator
- All around boundary wall with electric fence
- 2 no. car parking space for each flat and extra car parking for visitors
- Intercom system connection for every flat and all flats linked to the guard house
- Solar hot water system



**3 Bed  
Apartment**

## Lily Court Kusi Lane, Parklands

This spacious 3-bedroom, all en-suite apartment is conveniently located on Kusi Lane, Parklands.

### Features:

- All round boundary walls with electric fence
- 2 parking per flat and extra parking for guests.
- Large automatic standby generator for common services.
- 1 no. lift in the middle of the block.
- Borehole water
- Spacious open roof top terrace
- Sophisticated intercom system
- Underground RCC common water tank



**4 Bed  
Apartment**

## Brookside Terrace Brookside Drive, Brookside

These modern and spacious 4-bedroom apartments are located on Brookside Drive within close proximity to popular malls, schools, hospitals, restaurants and other social amenities. These apartments embody a warm and homely feeling making it the perfect place to invest

### Features:

- Additional storage space
- CCTV
- DSQ
- Entertainment Area
- Full Backup Generator
- Garden
- Gym
- Lift
- Parking
- Pool



**2&3 Bed  
Apartment**

**FOR SALE/  
TO LET**

## Silvermist Residency General Mathenge, Nairobi

Located on the prime General Mathenge Road, are this stunning 2 & 3 bedroom apartments with superb finishing's, panoramic views, and close proximity to malls, schools & hospitals. These immaculately presented apartments are set within a private and secure complex.

The modern apartments with warm accents across the rooms, have exquisite layouts with ample natural lighting and superb amenities to suit the urban lifestyle.

### Features:

- Rooftop terrace with gym and entertainment area
- Borehole and full backup generator
- Optimum size apartments with options of DSQ and stores
- Internet connectivity and MATV Plug and Play
- 2 high-speed lifts and 1 service lift

### Available:

**For Sale** – 3 Bedroom Apts

**To Let** – Furnished 2 Bedroom Apt



**4 Bed  
Apartment**

## Taarifa Gardens Taarifa Road, Parklands

Built with a keen detail for functionality and style, this immaculately presented apartment is set amongst manicured grounds within a private complex. As a resident you will have access to all lifestyle amenities with ease.

### Features:

- 4 bedroom all en-suite apartment
- Utility area with provision for a washing machine and separate entrance
- 2 Lifts per block
- Underground and terrace water tanks
- 2 parking slots per apartment
- 24 HR guard service, electric fence and CCTV
- Backup generator
- Borehole
- Gym, Steam & Sauna
- Swimming pool
- Party hall



**5 Bed  
Apartment**

## Casaurina Heights Forest Lane, Parklands

This spacious 5-bedroom apartment is located within close proximity to popular schools, hospitals, malls and other social amenities.

### Features:

- Parking Space
- Generator
- Garden
- Secured Compound
- DSQ
- Borehole
- 24 Hour Security



**3 Bed  
Apartment**

## Azalea Heights General Mathenge, Nairobi

This modern 3-bedroom apartment offers an unbeatable combination of luxury and convenience, located on General Mathenge.

It is within close proximity to business schools, hospitals, shopping malls, religious centers, community gathering places and other necessary social amenities.

### Features:

- Steam and Sauna
- Gymnasium
- Heated Swimming Pool with changing rooms
- Children's Play Area
- Entertainment Room
- 2 car park per apartment
- Commercial Floor
- Borehole



## Park Medical Centre (PMC)

### 3rd Parklands, Parklands

**Sizes Available:**

• 1,505 Sq.ft | 1,750 Sq.ft | 6,404 Sq.ft

**Features:**

- Partitioned office ideal for investment.
- Secure building
- Full Backup Generator
- Internet & TV connectivity
- Large AC plant area on every floor
- Modern washrooms & Kitchenette on every floor
- High-speed lifts
- Borehole with underground water storage
- CCTV, Intercom facilities



## Park Suites

### Parklands Rd, Parklands

**Sizes Available:**

Ground Floor Showroom of 4,483 Sq.ft

**Features:**

- Borehole
- High speed lift
- Reception
- Generator
- 24 hour security
- CCTV
- 3 level parking
- Firefighting equipment on each floor



## Valley View Offices

### City Park Drive, Off Limuru Rd

**Sizes Available:**

• Ground Floor - 1,500 sq.ft | 3,000 sq.ft | 6,000 sq.ft | 14,000 sq.ft

**Features:**

- 24/7 Security
- Gym & Fitness Centre
- Industrial Standby Generator
- Lift
- Parking
- Restaurants & Cafes
- Surveillance System



## Jahazi

James Gichuru Rd, Lavington

Jahazi offers high quality office accommodation, designed to international standards, offering occupiers a secure, highly efficient and flexible working environment. The high specification amenities include; standby generators, borehole, passenger lifts, security check & CCTV surveillance, electric fence, fire alarm & detection system make it an ideal office development for modern business requirements.

**Sizes Available:**

- 3,657 sqft
- 3,702 sqft
- 4,248 sqft
- Whole Floor – 11,517 sqft + Terrace Space 1,130 sqft



## Kaka House

Maua Close, off Parklands Rd

These offices are ideal for consulting firms. The building has an excellent design and boasts of ample natural lighting and ventilation.

**Sizes Available:**

- From 1,000 sq.ft – 4,000 sq.ft

**Features:**

- Lifts
- Kitchenette (Common area)
- Washroom (Common area)
- Water tanks
- Full backup generator
- CCTV surveillance
- Security guards
- Car parks



## The Radiance

1st Parklands, Parklands

Welcome to THE RADIANCE MALL, Your Premier Shopping Destination located on 1st Parklands Avenue under construction.

**Sizes Available:**

- Ground Floor: 525 sqft, 579 sqft, 790 sqft, 1911 sqft
- 1st Floor: 325 sqft (2 Units), 354 (2 Units), 1722

**Facilities:**

- Space layout: Ground floor, Mezzanine and 1st floor.
- Ideally utilized for Pharmacies, Opticians, fashion boutiques, cozy cafes, and many more
- Modern & Sustainable Design.



## The Chancery

Valley Rd, Kilimani

Open plan offices ideal for consulting firms.

**Sizes Available:**

- 2,101 sq.ft • 3,211 sqft
- 3,700 sqft • 3,620 sqft
- 3,394 sqft • 3,535 sqft
- 4,029 sqft

**Features:**

- High speed lifts
- High speed internet
- Full backup generator
- Ample and secure parking



## AIP Warehouse

Enterprise Rd, Industrial Area

For sale – 4.42 Acres with 28 Godowns. These Warehouses are located in the heart of Industrial Area in a secure complex.

### Features:

- Godowns with hardened floors and walls plastered
- Office Mezzanine floor has plastered walls and screed flooring
- Door height is 5.1M and centre height is approx. 9.4M
- Driveways are 22M wide with 2 Separate Gates
- Generator for the common areas and a Borehole
- Full fire system in each godown
- CCTV surveillance



## Giriraj Business Park

Eastern Bypass, Ruiru

Godowns of **11,000 sq.ft.**

### Features:

- In a compound of 9 godowns.
- Height 14m edge to ground.
- Hardened screed floors.
- 3 Phase Power Supply
- Each unit has 4 parkings



## Empire Business Park

Baba Dogo Road, Ruaraka

Empire Business Park consists of 46 Godowns on 9.5 acres: **7,530 Sq.ft & 11,696 Sq.ft**

### Features:

- The 40m roads between the warehouses.
- Top Grade Thermal insulation system in all godowns.
- All lighting within the warehouse is LED.
- The insulated roof, clear sheets with cyclones.
- Mezzanine floor weight allowance 500 kg/sqm.
- Fire exits to all godowns.
- Eaves Height 9m.
- A common staff canteen for the business park
- Common borehole with underground and overhead water tanks.
- Flexible Payment Plans
- Expected Investment Yield of 9%



## Serem Rd Godowns

Serem Road, Industrial Area

Godown of **52,830 sq. ft.**

### Features:

- The frontal yard comprises of 8 parking bays.
- The Godowns have their walls either lined in ceramic tiles or plastered and painted.
- Ceilings are open while floors are either finished in ceramic tiles or cement screed.
- Water is connected to city council and an onsite borehole.
- Electricity is 3 Phase supplemented by a standby 250 KVA genset.
- Drainage is connected to main sewer line.
- Ideal for a factory or a distribution center.





## LL Godowns

Lunga Lunga Rd, Industrial Area

Industrial spaces available on Mogadishu Road, off Lunga Lunga road. The units **3,535 SQF** and **3,500 SQF** are on the 1st floor.

This first-floor industrial space can accommodate a variety of businesses, such as;

1. Electronics assembly, food processing, woodworking shops
2. Printing and publishing businesses
3. Research and development labs
4. Art Studios and Workshops for their creative processes.
5. Fulfilment Centres for E-commerce businesses often



## Kenroid Complex

Off Mombasa Rd

Godown of **13,200 sqft**

Located off Mombasa Road on ICD Road, is an impressive development of godowns in a compound of 52 units.

### Features:

- Kitchenette
- Ladies and gents each floor
- Roofing: roofing sheets with cyclones
- Ample parking
- Water: city council, borehole
- Electricity : 3 phase power supply
- Secure Compound



## Safisha Complex

Baba Dogo Road, Ruaraka

Brand new warehouses of **6,698 sq.ft** to let in Ruaraka, Baba Dogo area in a compound of 5 units.

- Godown Finishes:
- Godown: Hardened floors and walls plastered
- Kitchenette- tiled
- Roofing: Insulated roofing sheets
- Toilets: tiles and fitted sanitary-ware
- Godown offices: Tiles, walls painted
- Parking: 2 parking's per godown



## Trafford Business Park

Mombasa Rd

Godowns of **8,400 sq.ft** each.  
Open Yard of approximately **37,000 sq.ft**

### Features:

- Godown heights 10.5m to top and 8.1m on the sides.
- Heavy duty insulation with cyclones and louvers.
- 3 phase power supply
- Secure compound with High boundary wall and CCTV surveillance.
- Fully tiled office spaces and washrooms.
- Adequate water supply.
- Office areas comprising of ground floor, first floor and second floor
- Fitted kitchenette.
- Bio digester plant installed.



0.4  
Acre  
Plots

## 108 Galu Breeze

Diani, Mombasa

These prime plots are situated on the stunning shores of Galu Beach, one of the finest beaches located in Diani, Mombasa. The central location in Diani allows easy access to the supermarkets, hotels and restaurants with direct access to the warm waters of the Indian Ocean

**Features:**

- Cabro internal road
- External boundary wall fence
- Internal walls between road and plot
- Plots separated by chain link fence
- Electricity and water connected to the plots
- Direct access to the beach from within the estate
- Unbelievable beach



0.5  
Acre  
Plot

## Pinewood Grove Plot

Pinewood Grove Estate, General Mathenge

This stunning property sits on 0.5 acres and offers an exceptional living experience in the heart of General Mathenge. Situated in a highly sought-after gated community, this gorgeous double storey home combines comfort, convenience and security.

**Features:**

- Property sits on 0.5 Acres
- 8 Bedrooms
- 6 en-suite
- Garden
- Ample Parking
- DSQ
- Gated estate



0.73  
Acre  
Plot

## Manyani Plot

Manyani East Road, Lavington

The site is rectangular in shape, contains red soil, and is currently home to a double-story house in the traditional style.

The position and shape of the land, which is connected to the mains for electricity and water, present a perfect opportunity for conversion into multi-dwelling townhouses in keeping with the neighborhoods character, subject to securing the appropriate approvals.

This land is within close proximity to popular shopping malls such as The Junction Mall, The Lavington Green Mall, ABC Place and Valley Arcade making the location a desirable place to invest.



## 108 Leopard Whispers Masai Mara

Experience the East African Wildlife in all its raw beauty with a unique opportunity, to build your own exclusive holiday home on a 2-acre plot at 108 Leopard Whispers, a controlled estate bordering Masai Mara.

### Project Highlights:

- 60 acre plot subdivided into 2-acre plots
- Plot goes down to the river – generally flat topography with a slight gradient sloping towards the river
- 4 Km from Sekenani Gate
- Bordering Nashulai Conservancy
- Easy 4 hour drive from Nairobi
- Short 45 min flight from Wilson Airport



## Mombasa Rd Plots Mombasa Road

This 5 & 7 acre prime piece of land is conveniently located on Mombasa Road. Perfect for commercial or industrial use. Surrounded by well-developed business infrastructure, this plot is a natural choice for investors looking to grow and expand their businesses.

### Features:

- The parcel of land fronts Mombasa Road opposite Delta Plains.
- Full fenced with a perimeter wall.
- Surrounded with commercial developments.
- Close proximity to signature mall and Mombasa cement.
- Ideal for industrial, warehouse or commercial use.
- Approximately 3.2 km to the Nairobi Expressway.



## Garden Estate Plot Kigwa Road, Garden Estate

This flat, 0.62 acre parcel of land is a great investment opportunity! It is located in the upmarket suburb of Garden Estate on Kigwa Road. This plot is a stone-throw away from Braeburn Garden Estate school and is within close proximity to Ridgeways mall.

It is an excellent plot to build your dream home.

### Features:

- Rectangular in shape
- Flat Land
- Boundary Wall

# Dunhill

CONSULTING LIMITED

Professional • Cost Effective • Hassle Free

#### **DISCLAIMER**

Dunhill Consulting Ltd hereby give notice that: -

No description or information given whether or not in these particulars and whether written or verbal about the property or its condition or its value may be relied upon as a statement or representation of act.

Neither Dunhill Consulting nor any joint agents have any authority to make any representations and accordingly any information given is entirely without responsibility on the part of the sellers(s) or lesser(s).

These particulars do not constitute, nor constitute part of, an offer or contract, nor shall they merge in any offer or contract which may be made between the sellers or lessors and the recipient of the information.

The computer-generated images show only certain parts of the property at the time they were taken.

Any areas, measurements or distances given are approximate only.

Any reference to alternations to, or use of any part of the property is not a statement that any necessary planning, building regulations or other consent has been obtained.

These matters must be verified by an intending buyer or lessee.

Any buyer or lessee must satisfy himself by inspection or otherwise as to the correctness of any information given.

## Contact Us

15 Hevea Court, Eldama Ravine Rd,  
Westlands - Nairobi.

**T.** +254 786 386 445 | +254 735 267 825  
+254 720 911 136

**E.** [sales@dunhillconsulting.com](mailto:sales@dunhillconsulting.com)

**W.** [www.dunhillconsulting.com](http://www.dunhillconsulting.com)